

Learning at Pashley is
an amazing adventure!

OUR PROSPECTUS



Pashley Down Infant School

Beechy Avenue, Eastbourne, East Sussex BN20 8NX

Telephone: 01323 730719

Email: office@pashley.e-sussex.sch.uk

Website: www.pashley.e-sussex.sch.uk

@pashleydownschool

@pashleydown

Headteacher: Andy Best

Deputy Headteacher: Emma Lewis

Inclusion Leader: Mrs Sharon Souto

Chair of Governors: Ms Jennifer Cruse

Thank you for showing an interest in our school; we hope that you will find the following information interesting and helpful. We are always pleased to show parents and their children around the school. To make an appointment to visit the school, please phone the school between 9.00am and 4.00pm on any weekday. Do leave a message if you can't get through and we will call you back. The information in this prospectus is accurate at the time of going to print (October 2024).

Design & Artwork by PRG Marketing Communications



Headteacher's Welcome

The first thing that strikes you when you walk around Pashley Infant School, is the warm and positive ethos that permeates throughout the whole community. Pashley isn't just a school, it's a family.



The school site itself is unique with its woodland, class allotments, beehive, chickens, rabbits, guinea pigs and pond. All of these underpin an outside learning curriculum that creates a daily awe and wonder for our children. Across our whole curriculum, we are driven by the belief that every child has a right to reach their full potential through innovative projects designed by our staff and high-quality teaching, constantly striving to deliver the very best we can.

We are very proud of the strong partnership we have with our families and we regularly invite parents in to be immersed in their child's learning. Please do come and visit us so you can see Pashley in action, meet our staff and children and see what they all have to say about the school.

Please contact our friendly office team and arrange a visit and see for yourself that learning at Pashley is indeed an amazing adventure.

Andy Best

Our Pashley Values

- Kindness
- Positivity
- Honesty
- Resilience
- Respect
- Independence

These values are the building blocks of our school ethos, which create a tolerant and caring environment for all of our learners. Children are celebrated for demonstrating these values, receiving special awards and cuddles with our Pashley Values mascots, the Koala of Kindness, the Panda of Positivity, the Otter of Honesty, the Iguana on Independence, the Rhino of Respect and the Raccoon of Resilience.

A Pashley Challenge

At Pashley we organise our 270 pupils into 9 classes, each named after a creature that you may find in woodlands like ours. Can you spot all 9 creatures as you look through the following pages and find out more about learning at Pashley?

The Pashley Vision

We promise to have kindness at the heart of everything we do. We believe every child can achieve their dreams by providing an outstanding curriculum for all children in our care. Every adult begins as a child:

At 4, David Attenborough collected fossils, stones, and natural specimens, he was fascinated by natural history.

We open the door to awe and wonder.

At 5, Rosa Parks lived on a farm not knowing yet she was going to change history.

We empower children to develop resilient hearts who stand up for what is right.

At 6, JK Rowling read fantasy stories to her sister. Years later, after 12 rejections, Harry Potter was published.

We teach children to remain positive, not frightened of failure.

Together, in our community, we honour and uphold our school values. We believe gratitude is central to happiness for all.

It is our privilege to shape future generations.



A Pashley Day...

Our weekly 21 hours of teaching is broken into morning sessions and afternoon sessions. All dietary requirements can be catered for in our school canteen, or packed lunches are welcome. We run an Earlybird club and Ladybird club for those children who need to spend a bit longer with us to allow for other family commitments, or just want to play and make friends. Further costings and details are available from our main office or school website. For any direct queries please email magicbooking@pashley.e-sussex.sch.uk.

7:45am

Earlybirds breakfast club begins. Drop-off can be staggered to meet your needs.

8:30am

The school gates are open! Your child can make their way straight to the classroom for early morning work, followed by reading.

8:50am

The school day officially starts! Your child will need to be in class by this time for the register.

10:30am

15 minute morning break and KS1 fruit and milk.

12:00pm

Lunchtime begins! EYFS and Key Stage 1 eat and play at different times, but everyone gets time to eat, relax and play!

13:00pm

Afternoon lessons commence, often with phonics.

15:00pm

End of the school day! Children are dismissed by their class teams.

15:00–18:00pm

Ladybirds club runs with games, activities and a healthy snack.



Project Learning and The Great Outdoors!

The children enjoy our varied Projects which are based on the REAL approach meaning they are:

Rigorous
Engaging
Authentic
Learning

The projects have real life links, trips and expert visitors so they build on knowledge and skills, with children enjoying hands on learning wherever possible. One of the Year 2 children's favourite projects is 'Start with Art'. Children become immersed in styles of different artists having the opportunity to experiment with different art techniques leading to an art exhibition where they proudly invite visitors to enjoy their learning.

Many of our projects are linked with our rich outdoor learning environment. For example our EYFS children learn the story of The Little Red Hen by a visit to the Pashley farm and seeing our chickens. Classes even have Buttercup, our own Little Red Hen, visit their classrooms to bring the story alive! In Year 1 the children learn all about our trees with learning in our woodland and interactive activities to identify the characteristics of the many beautiful established trees on site. In Year 2 the children learn about bees and visit our allotment which has two hives and see how Pashley bees are an amazing part of our natural world.



Life Skills and Values

At Pashley we place the highest value on children's health and wellbeing. The children learn through the Pashley Mascots about the Six Pashley Values of Positivity, Kindness, Honesty, Resilience, Independence and Respect. Each mascot is represented by a cuddly animal so you may well see a 5 year old walking up the corridor with a cuddly Koala of Kindness which they are 'looking after' for the week as a reward for being recognized as a particularly kind child in their class. Having this infant friendly approach with the mascots really means that these values are interwoven in to school life and are referred to often throughout the school day, including in assemblies.

Children also enjoy weekly 'Circle Time' activities where the adults and children discuss real life issues and work together. Activities informally encourage unity, respect, turn-taking and working together towards a shared vision.

We are proud to be forward thinking school and run sessions which help children to regulate their emotions in a calm and supportive environment. These take place in small groups and with the whole class.

Children gain knowledge and understanding about how to keep safe and healthy and are taught the basics of health, hygiene and personal safety.

As with all areas of school life we work closely with people beyond school including the emergency services, the NSPCC and networks of adults passionate about the environment we live in.



Reading, Writing and Phonics

At Pashley we place a high importance on children developing a love of reading alongside gaining the skills to become an independent and confident reader. We use a number of different schemes and these are linked to the phonics sounds that the children learn. The school has invested in a high number of quality texts and everyday adult read story books to encourage their love of reading and ignite their imagination. We live and breathe quality children's books at Pashley with regular visits from authors, poets and storytellers.

Children are able to take books home to read and enjoy. These books are linked to the children's phonics phases they are learning in class. We teach early reading decoding skills (Phonics) and comprehension skills to the children from the minute they enter the door, so we have confident readers very quickly.

We have a strong reputation for our teaching of Early Reading/Phonics locally. In 2016 Mrs Lewis, our Deputy Headteacher, set up the Pashley Phonics Hub, a training facility for East Sussex teachers. The Phonics Hub continues to provide training across county schools including whole day events and bespoke support, working with individual schools. Our teachers model lessons to groups of visiting teachers regularly which we are very proud of.



The teaching of Writing at Pashley is fun and purposeful for the children. As all children have such a strong start in Reading, we bring in stories and phonics to teach children to learn stories and poems by heart from day one, learning how to write simple words as they progress in their phonics learning. We bring in stories and quality text so children write about things that are meaningful and have purpose. Children also write in other areas of the curriculum giving them plenty of practice and a breadth of learning. In all writing the children are skillfully guided – for example, the teacher reading a text to (and with) the class or working with the class to model skills. We use a variety of different strategies to support all children becoming writers including, most recently, Talk for Writing. The Talk for Writing initiative has been shown nationally to grow confident independent writers fully including children who have been reluctant writers. We are very proud of our teaching of Writing, just take a look in our books and you will see that our presentation, handwriting and the quality of our children's writing is excellent.



Maths Mastery at Pashley

The Maths Mastery approach is consistently high across the school. The aim of this approach is for all children to develop a deep understanding of the mathematical concepts they need in order for them to feel confident using Maths throughout their lives. We hold high value in the teaching of early Maths skills. Children are taught Maths daily throughout the school focusing on fluency, reasoning and problem solving.

From EYFS through to Year 2 teachers carefully select resources to help children understand the Maths they are learning at a deep level. Children gain knowledge through 'hands on' concrete resources, moving to pictorial representations then lastly moving to an abstract (written) approach.

You will see from looking around school that Maths is highly regarded and enjoyed! We even have a playground dedicated to Maths to encourage children to play Maths games if they choose! We believe it is vital for children to love maths, become confident Mathematicians and able to understand the relevance of Maths in real life.



Outdoor Learning and Science

OUTDOOR LEARNING

We have an amazing and rich environment for our children to learn about nature and use our outdoors extensively. Such is our commitment to the outdoors that we employ a full time specialist, known to one and all as “Mrs Hutch”! Mrs Hutch works alongside the Pashley Teaching Team to help the children learn all about their immediate environment and how we should all care and look after it. Every year the children have a series of bespoke lessons planned carefully to link with the outdoors.

The areas around the school include:

- The allotments with the Eco Green House (opposite the main pedestrian entrance)
- The Pashley Pond
- The Pashley Farm (Cluckingham Palace and Carrot Cottage)
- The Woodland with the linked Outdoor Classroom The N.E.S.T.
- The Wildlife areas
- Bee Hives
- Bug Hotels for insect spotting
- The Polytunnel

We are so fortunate to have a wealth of a variety of trees and plants around the school and this creates a magical feel to a school that is literally nestled into the foot of the South Downs.

The children go out in all weathers and the school provides wellies and wet weather gear for all ages. From EYFS to Year 2 children become adept at changing their wellies and pulling on snugly all in ones so they can fully enjoy the outside.

We have just started “Woodland Wednesdays” where 15 children spend time learning forest school skills such as making fires and whittling wood. All children get this opportunity for 12 weeks of their Pashley career.

Our Inclusion Team encourages children to use nature and animals to self-regulate and use the ample opportunities for nurturing and team work.

Take a look at the map on the back page and see if you can spot all the outdoor areas of learning!

SCIENCE

The majority of our science learning comes from outdoor learning opportunities. We encourage children to take a lively interest in the World around them and become mini scientists! They follow the national curriculum and use investigative skills to learn about life processes, plants, living things, seasonal changes, materials and their properties.

Throughout their time at Pashley, the children work scientifically and take part in practical experiments which help them to learn about their senses, living things and the properties of natural and human-made materials.

We are very proud to have earned the ‘Primary Science Quality Mark’ and to have been credited for providing consistently outstanding learning opportunities. Our Science results at the end of Key Stage One have been consistently above National Average for many years.



We encourage children to develop the magical awe and wonder beyond their immediate environment.

The Arts at Pashley

OUR VISION

Children will leave Pashley with a love and passion for the arts, having been exposed to freedom and opportunities to explore and enjoy the subject in all areas of their school experience.

At Pashley children are given the opportunity to explore the arts in their everyday learning. Each year we ensure children have the chance to get involved in:

- Year group plays and concerts
- Participating in seasonal themed events
- Visits from exciting guests such as:
 - Musicians
 - Storytellers
 - Writers
 - Artists
 - Theatre Groups

Children learn a range of art skills and techniques as they journey through the school such as clay modelling, sketching, singing, playing musical instruments and many more.

We aim to embed the skills they have learnt through art into their everyday lives and hopefully into after school activities. At Pashley we are very passionate about giving the children the chance to use their imagination and creative skills to develop a strong foundation for the arts, which will not only accompany them on their school journey, but influence their future lives. We enjoy using a dedicated Art and DT room in the school where groups and whole classes can take part in exciting learning opportunities.

We are proud to hold the National Award at Pashley. In Year 2 the children visit Hastings Contemporary Art Gallery and put on an exhibition of their own for parents in the hall.



Learning about the Wider World

HISTORY AND GEOGRAPHY

Many of our projects have a historical or geographical theme. We aim for all our infant children to gain that sense of awe and wonder from building on what they see around them and using rich resources to deepen their knowledge even further.

The projects are relevant, exciting and accessible for all children ensuring that children build on previous knowledge and learn new facts and skills. Children are helped to relate their personal experience to an awareness of the past, present and the future, appreciating the world around them.

We teach history and geography through photos, music, souvenirs, artefacts, looking at books and atlases. With the school situated at the foot of the South Downs, within just a short walk children can view the Old Town and all of Eastbourne from a high position and see historical and geographical features for themselves. What a great starting point for children to become history spotters and map makers!

RELIGIOUS EDUCATION

Pashley is a multi-cultural environment. We are keen to expose children to a range of religious and traditional festivals, including Easter and Christmas as a whole school. We use stories, poetry, visits and visitors to help the children gain knowledge and develop respect for the views and beliefs of all people.

In KSI children visit our local church and also take part in a virtual tour of Synagogue. We have a large range of hands on resources and expertise to share with the children.

We warmly welcome and encourage families who hold other religious beliefs to share their traditions and celebrations with us.



Sport and Computing

PHYSICAL EDUCATION

Throughout their time at Pashley, the children have lots of opportunities to engage in different sports and physical education activities. We believe by encouraging children to try a variety of sport in Physical Education children are more likely to see movement and activity as a natural part of their everyday life and therefore grow into healthy teenagers and adults.

Within the first few weeks of arriving at Pashley our EYFS children have the opportunity to learn how to ride a balance bike and quickly become confident and proficient riders. The school has invested in balance bikes for EYFS and Year 1 so this enjoyable activity continues into Key Stage One. All children take part in at least two PE lessons each week, including gymnastics and dance at points in the year.

Children have access to large play equipment on the playgrounds and terrace. All the children particularly enjoy the adventure playground and the trim trails which are used daily, on a rota basis. We have invested in training opportunities for all our teachers and class learning assistants and are very fortunate to have a specialist sports coach to enhance our PE in school. We recently were delighted to be awarded the Gold Quality Start Award for our provision and commitment to PE.

We warmly invite parents to Sports Day in the Summer which is usually held at Ocklynge Junior School on their large open field. It's a great event which is enjoyed by us all!



COMPUTING

Using computers and technology is part of day to day learning at Pashley. All the classrooms have modern interactive boards and visualisers are used in everyday teaching practice. We also benefit from digital visualisers and programmable 'robots'. In EYFS the children have access to iPads and are able to use appropriate educational apps from practicing cursive handwriting to classifying leaves and plants.

In Key Stage One children benefit from using a class set of laptops where they are able to become familiar and confident using educational virtual platforms to enhance their learning. Many children, in today's modern 'touch screen' society are unfamiliar with keyboards so this is an important skill to develop even at infant age.

The children also learn the basics of computer science, which relates to teaching basic algorithms needed to code a machine and learning how digital systems work. For example, giving and following simple instructions to build Lego models, or navigating a maze.

An essential part of every child's education is safeguarding and this includes online e-safety. Every class have dedicated age appropriate lessons on how to keep safe online and also supports families with safety guidance for home.



The Wider Pashley Team

THE GOVERNORS

The school is very fortunate to benefit from a dedicated board of Governors who are committed to the school. We have representatives from education, local businesses, parents and staff. Each of the Governors is allocated to a specific area in school which cover the Subject areas, the buildings, safeguarding and provision for vulnerable pupils.

FRIENDS OF PASHLEY (FOP)

The FOP are legendary and consist of a dedicated group of parents who work (and play!) extremely hard to organize fund raising and social events. School staff work closely with the FOP team and the community spirit is very much alive. Annual events include the fabulous fairs, at Christmas and in the Summer, The Pashley Easter Egg Hunt, Quiz nights and more.

COMMUNITY LINKS

Pashley is very much part of the community, so much so we have a dedicated teacher who oversees links and leads social media as part of her role. We make use of our Old Town library, have links with local churches and promote community support such as food banks and mental health support.

We also work closely with other Old Town schools including Motcombe Infants, Ocklynge Junior and South Downs Community Schools. Our links with other schools in Eastbourne mean that we can share expertise, experience and excellent practice.

We pride ourselves on excellent communication with parents and have a high positive presence on social media so please do follow us on Facebook, Twitter and Instagram to get a feel of the school.

HEALTHY EATING

All children at infant age are entitled to a free school meal and a free healthy snack everyday. We passionately believe that happy children learn when they have a balanced healthy and varied diet.

We took the decision to change our current catering company, Harrisons. Our wonderful chef Kylie and her friendly team are adept at catering for children with allergies. Kylie also takes the time to try new recipes with 'secret healthy ingredients', for example her chocolate beetroot brownies which are a hit with all children. Since moving companies the take up of meals has increased, the children eat more and the feedback has been overwhelmingly positive. We only want the best for the children at Pashley.



Wrap-around-care, Clubs and Uniform

EARLYBIRDS AND LADYBIRDS

For working parents who require wrap around care we are very fortunate to manage this 'in-house' with a dedicated team who are also part of the support staff during the day. This has huge benefits as the children form positive relationships in day to day school life and also see these friendly familiar faces before and/or after school.

Earlybirds begins at 7.45am and the children can have breakfast of yoghurt, cereal, toast and juice. Ladybirds begins straight after school until 6pm. The children enjoy a sandwich, biscuit and drink (allergies are also catered for).

Both clubs are situated in the aptly named 'Happy Hive'. This is on the school site and also benefits from having the all weather playground, the activity trim trail and pirate ship which the children love! Parents are able to book sessions online.

OTHER CLUBS

We also host a number of other clubs using out-of-school providers. Currently these include gymnastics, karate, tennis, yoga, football and the great out-tours. Parents who wish to use the Ladybird club afterwards are able to do so.

PASHLEY SCHOOL UNIFORM

- Green jumper or cardigan
- Grey trousers, shorts, skirt or pinafore
- Yellow or green summer dress
- White polo shirt
- Yellow or green sun hat

PE KIT

- White t-shirt
- Black shorts
- Tracksuit (when cold)
- Trainers (with Velcro fastening if possible)
- Named PE bag

We are always happy to show you around our wonderful school. It is best seen in action! Do give the office a call and book in a tour with a member of the senior leadership team for a time that suits you. 01323 730719



Our Allotment is opposite
the school



Main Entrance
On Beechey Avenue

Earlybirds and Ladybirds
happen in the "Happy Hive"

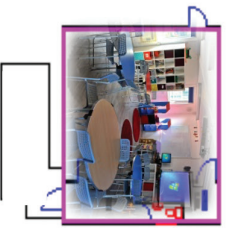

To the "Field", "Trim-trail"
& "Pirate Ship"

"MUCA"
(Multi-usage games
area)



Way in for
a warm
welcome!

Follow the path round to the main playground,
"Outdoor PE Area", "Music Garden", "Adventure
Play", "Nature Garden", "The Fort" and the
"EYES Terrace"

Have a wander...

We are so proud of our Pashley grounds.
Use this map to guide your own Pashley adventure
and find some hidden gems.

DID YOU FIND:

- Cluckingham Palace?
- The Bug Hotel?
- Giant musical instruments?
- A sand filled boat?
- The story-telling throne?
- A multi-coloured slide?
- The Pashley Values board?
- The Woodland Classroom?

How many animals are there?

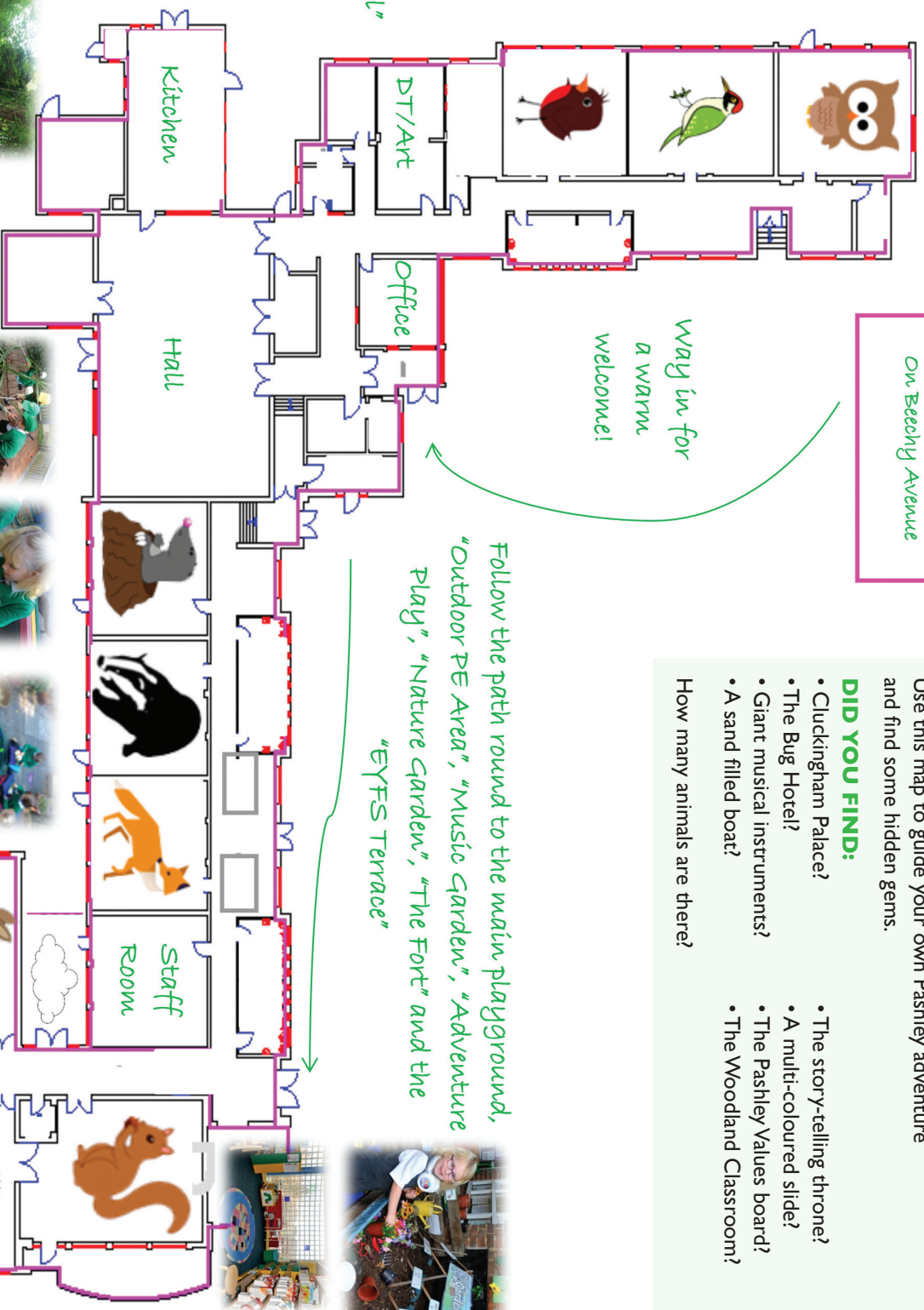

To the "Woodland" through the "Enchanted Garden"

"Pashley Farm"

